

A Harris Esq^r

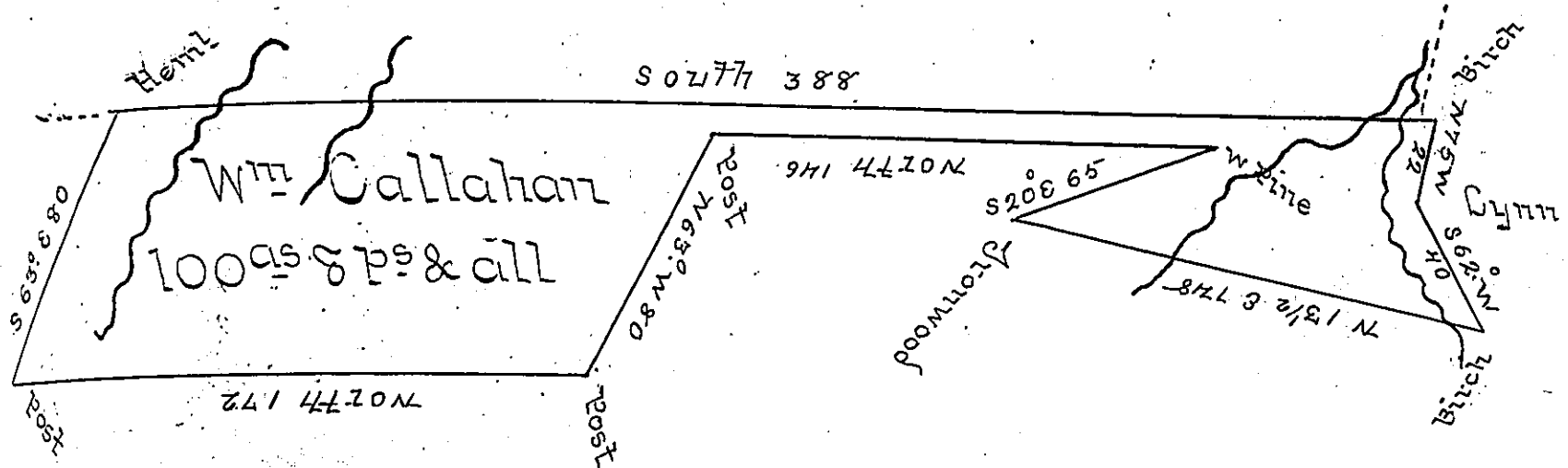

Surveyed the above described Tract of land for W^m Callahan on the 20th of January 1830 in pursuance of his Warrant dated January 6th 1830 Containing one hundred acres and eight perches and allowance of six per cent for Roads & situate in s Brown Township Lycoming County on the South Side of Pine Creek about 16 Miles from the Mouth of said Creek

J. A. Gamble U.S.

To Gabriel Hiester Esq^r }
 Surveyor General }

IN TESTIMONY that the above is a copy of the original remaining on file in the Department of Internal Affairs of Pennsylvania, made conformably to an Act of Assembly approved the 16th day of February, 1833, I have hereunto set my Hand and caused the Seal of said Department to be affixed at Harrisburg, this third day of April 1900.

James W. Fatta
 Secretary of Internal Affairs.